

DISCLAIMER OF LIABILITY

Dear Valued Customer,

Thank you for purchasing a high-quality DXP product. Please review the following important information before installing and using your new part:

1. **Proper Installation**

This product is intended for professional installation by a certified mechanic or experienced professional. Improper installation or modification may result in damage to your motorcycle and void any warranty.

2. **Limited Warranty**

DXP guarantees that this part has been manufactured to high-quality standards. However, this warranty is limited to defects in materials and workmanship. We are not responsible for issues arising from improper installation, misuse, or modifications.

3. **Assumption of Risk**

Motorcycle customization inherently involves risk. By installing this product, you assume all risks associated with its use, including potential damage to your motorcycle or injury. Always use proper safety equipment and techniques.

4. **Compliance with Local Laws**

It is the buyer's responsibility to ensure this product complies with all local regulations and laws applicable in your area.

5. **Return Policy**

Returns are accepted within 90 days of purchase for unused and uninstalled products, subject to our return policy. Shipping fees are non-refundable.

If you have any questions about the installation or use of this part, please contact us at info@ridedxp.com.

Ride safely,

DXP Team





TABLE OF CONTENTS

Dyna Mid Control Crash Bar Installation Steps	1
Dyna Mid control Crash Bar Parts Diagram	2
Dyna Billet Plate Replacement Diagram	3
M8 Softail Mid Control Crash Bar Installation Steps	4
M8 Softail Mid Control Crash Bar Parts Diagram	5
M8 Softail Billet Plate Replacement Diagram	6

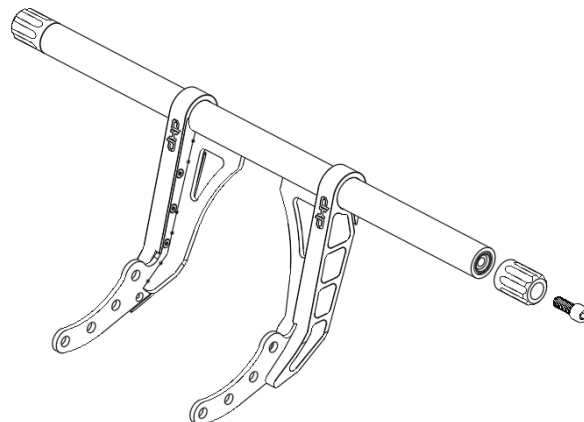

INSTALLATION GUIDE - DYNA 2006 AND UP



Overview of the kit

Includes

- 1x Pre-assembled main bar with billet plates
- 2x Delrin Sliders
- 2x Delrin Slider bolts $\frac{1}{2}$ -13 x 2"

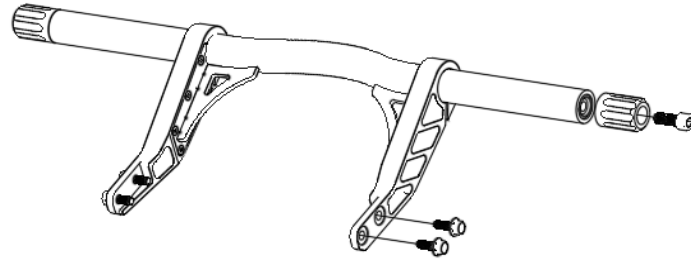

Installation Steps

1. Before you begin the DXP crash bar installation, make sure the bolting area on the frame is clean and no components (stock crash bar or pegs) are bolted in its place. Keep stock hardware as you will be reusing it to mount the crash bar. Tip: If you have a $\frac{3}{8}$ -16 tap we highly recommend cleaning the threads before installation. Refer to the owner manual if need be.
2. Slowly slide the billet main plates on your DXP crash bar to align the mounting holes to the threaded holes on the frame.
3. While holding the crash bar in place thread the 4x $\frac{3}{8}$ -16 bolts and washers through the billet plate into the threads on the frame.
4. Make sure no wires or cables are pinched while bolting it in.
5. Torque the 4 mounting bolts to **25 ft-lbs**.
6. Install the Delrin ends with the supplied $\frac{1}{2}$ -13 allen head bolts and torque them to **15 ft-lbs**.

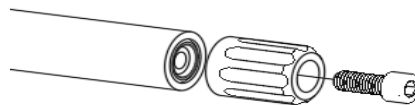

Message us for any further questions.

info@ridedxp.com



INSTALLATION GUIDE

DYNA CRASHBAR

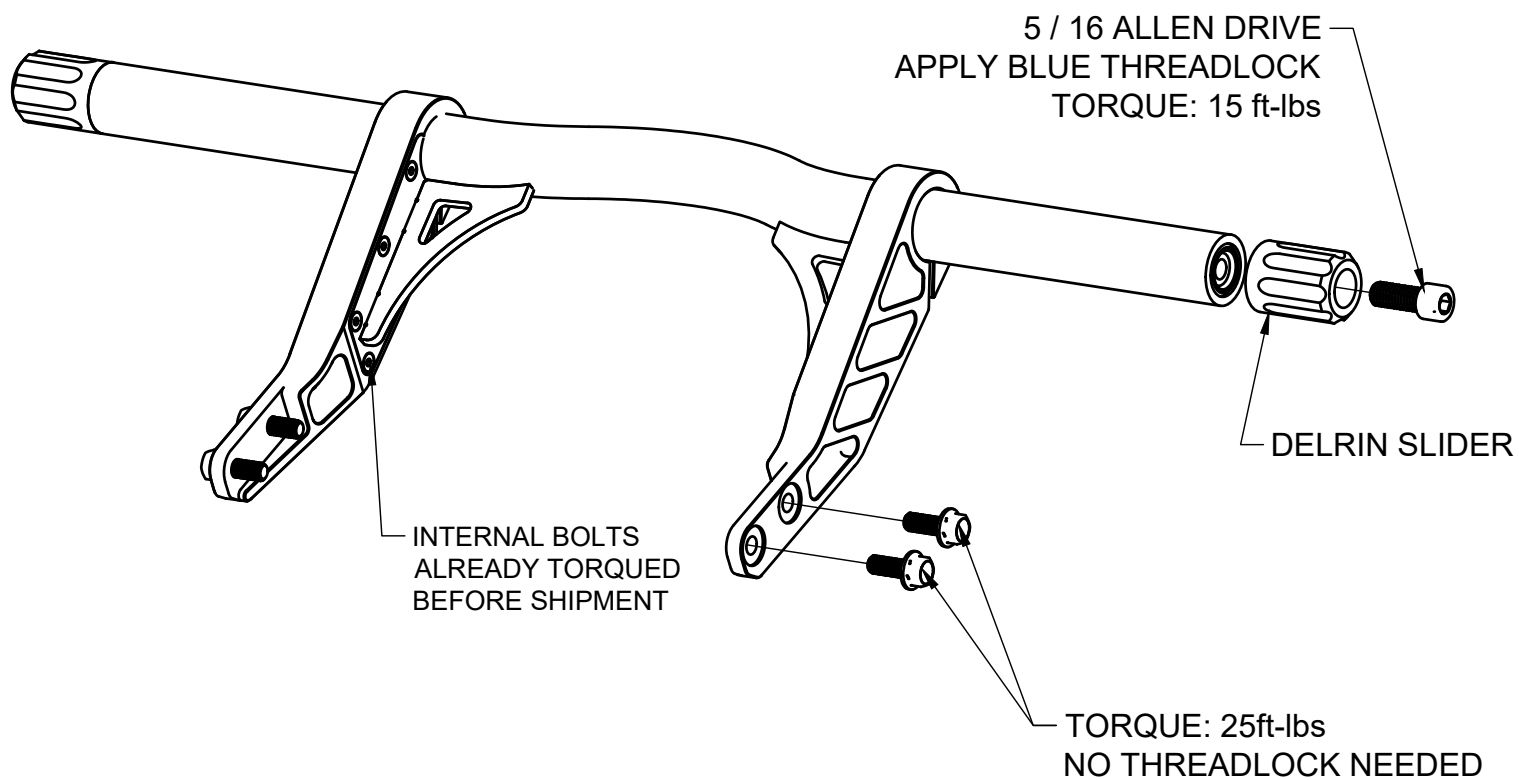



INSTALLATION GUIDE

DYNA CRASHBAR BILLET REPLACEMENT

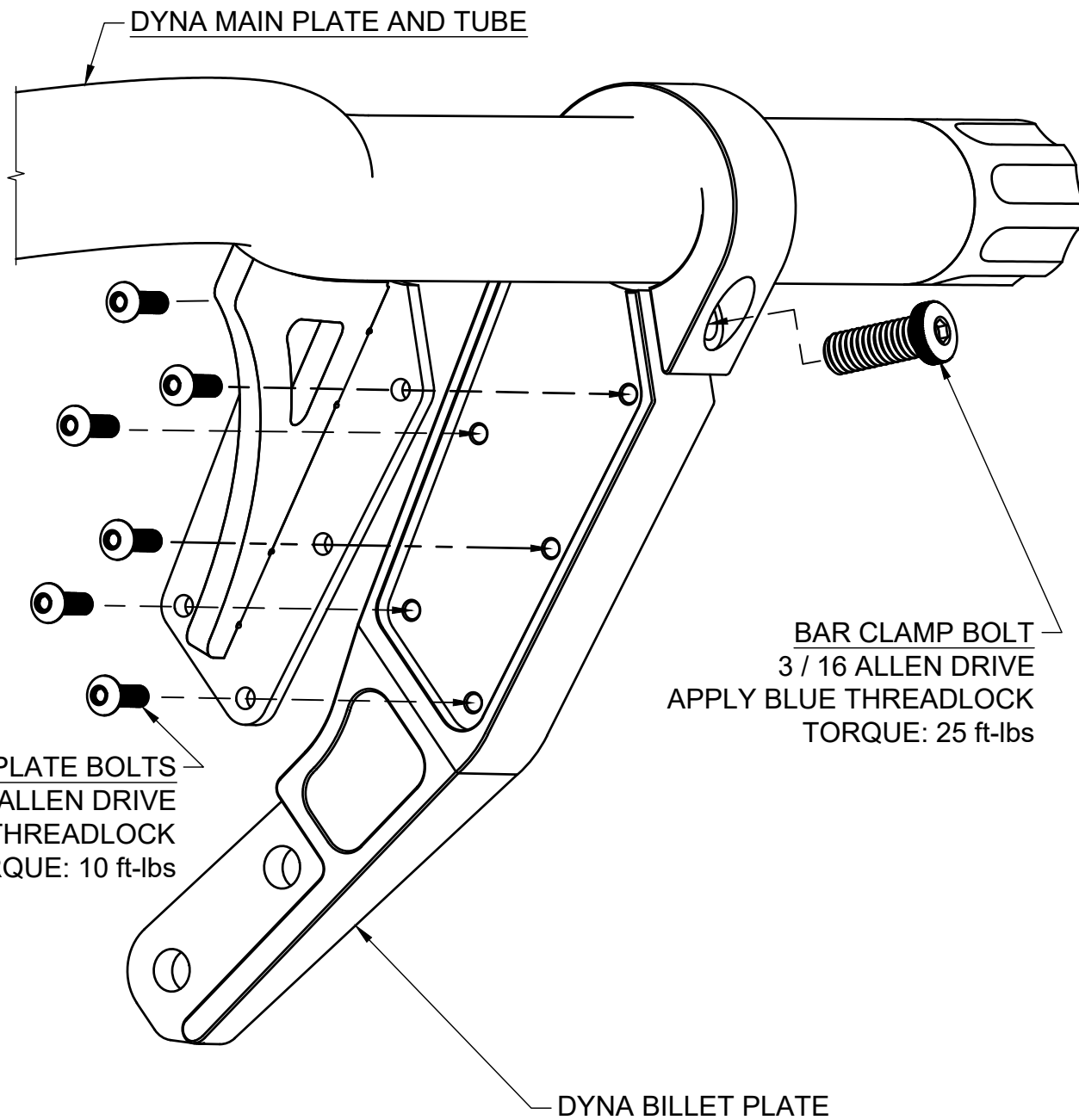

For help email us:
info@ridedxp.com

INSTALLATION GUIDE - SOFTAIL MID CONTROL



Overview of the kit

Includes

- 1x Pre-assembled main bar with billet plates
- 2x Delrin Sliders
- 2x Delrin Slider bolts $\frac{1}{2}$ -13 x 2"
- 5x Mounting bolts $\frac{3}{8}$ -16 x 1.75"
- 1x Mounting bolt $\frac{3}{8}$ -16 x 1"

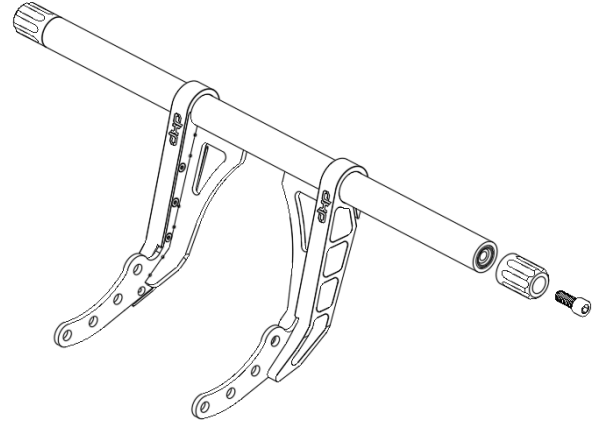

Installation Steps

1. Remove stock Softail peg mounts from both sides as well as the brake assembly on the right side. You do not need to undo the lines to the master as the crash bar slides in between and does not take any room towards the top. Refer to the service manual if needed. You may put away stock mounting hardware, you will not be needing them.
2. SLOWLY slide in the crash bar to match the holes you have just removed the mounting hardware to the holes on the crash bar. Add the second to last bolt starting from the front on each side to secure it onto the bike.
3. Re-assemble the brake and foot peg assembly on both sides. Do not torque the bolts yet.
4. Make sure the crash bar is not binding on anything or pinching cables.
5. Torque all frame bolts to **25 ft-lbs**.
6. Install both Delrin sliders with supplied $\frac{1}{2}$ -16 2" bolts and torque to **15 ft-lbs**.



Message us for any further questions.

info@ridedxp.com



INSTALLATION GUIDE

LOWRIDER SOFTTAIL CRASHBAR

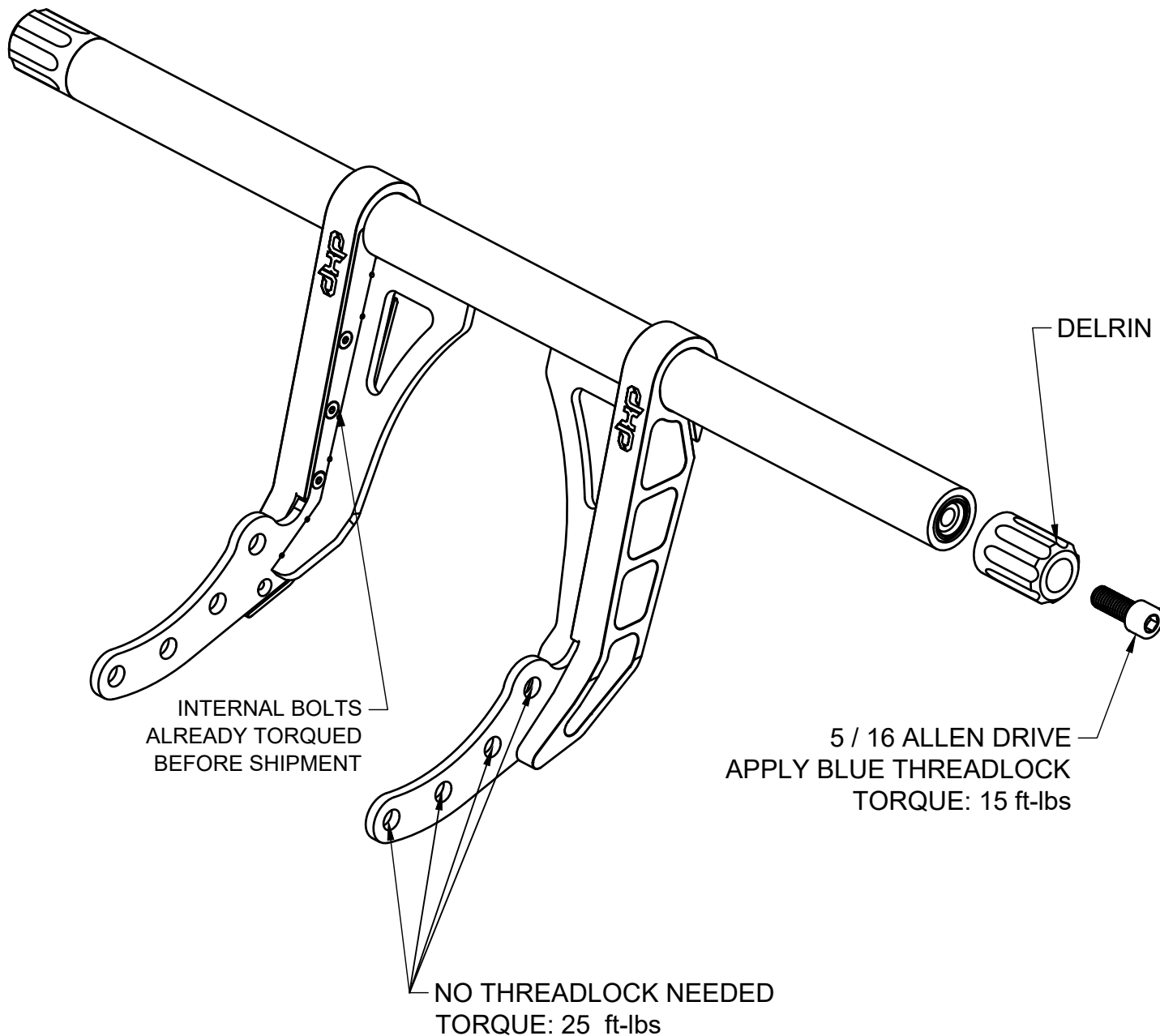

For help email us:
info@ridedxp.com



INSTALLATION GUIDE

LOWRIDER CRASH BAR BILLET REPLACEMENT

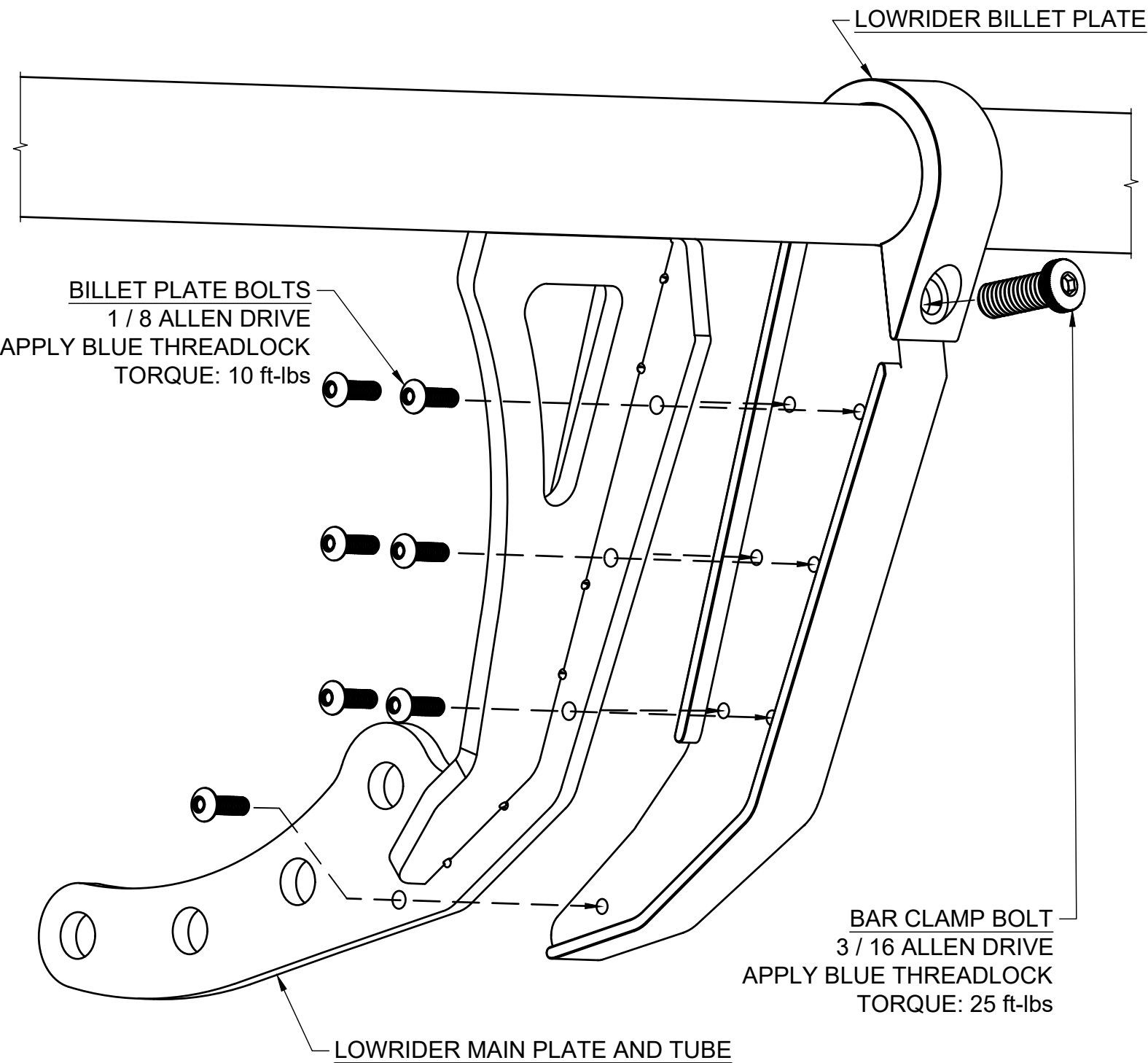

For help email us:
info@ridedxp.com