

DISCLAIMER OF LIABILITY

Dear Valued Customer,

Thank you for purchasing a high-quality DXP product. Please review the following important information before installing and using your new part:

1. **Proper Installation**

This product is intended for professional installation by a certified mechanic or experienced professional. Improper installation or modification may result in damage to your motorcycle and void any warranty.

2. **Limited Warranty**

DXP guarantees that this part has been manufactured to high-quality standards. However, this warranty is limited to defects in materials and workmanship. We are not responsible for issues arising from improper installation, misuse, or modifications.

3. **Assumption of Risk**

Motorcycle customization inherently involves risk. By installing this product, you assume all risks associated with its use, including potential damage to your motorcycle or injury. Always use proper safety equipment and techniques.

4. **Compliance with Local Laws**

It is the buyer's responsibility to ensure this product complies with all local regulations and laws applicable in your area.

5. **Return Policy**

Returns are accepted within 90 days of purchase for unused and uninstalled products, subject to our return policy. Shipping fees are non-refundable.

If you have any questions about the installation or use of this part, please contact us at info@ridedxp.com.

Ride safely,

DXP Team



INSTALLATION GUIDE - FOOT PEG

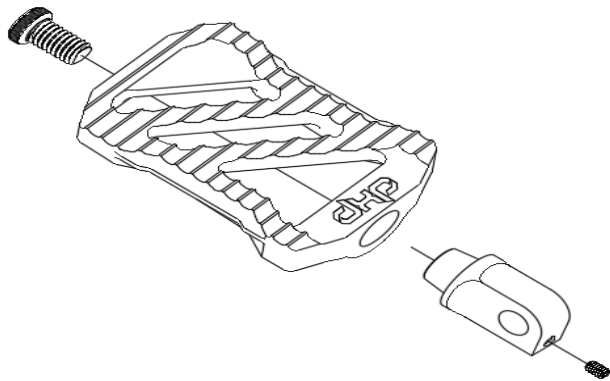

Overview of the kit

Includes

- 2x Billet foot pegs
- 2x Stainless Steel Clevis
- 2x Clevis bolts $\frac{3}{8}$ -16 x 0.625
- 2x Clevis set screws

Installation Steps

1. Remove OEM or current foot pegs. Make sure to be careful when removing the circlip on the retaining pin as it may launch itself when removing it. Keep all stock hardware as you will be reusing it.
 - 1.1. For Dyna, XL, FXR and passenger bagger pegs the clevis is full and only has a spring washer on one side. Make sure not to lose this spring.

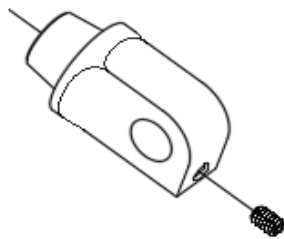

- 1.2. For 2018+ M8 Softail and front pegs on Pan Americas the clevis has an opening in the middle for a rotating spring. Make sure not to damage or lose this spring when removing the peg as we will be reusing it. Make sure to note OEM spring orientation for later.

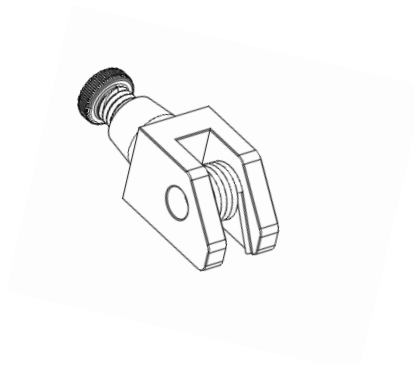

INSTALLATION GUIDE - FOOT PEG



2. Slide the DXP Stainless clevis first onto the footpeg mount. Insert the spring washer in between the clevis and mount then slide retaining the pin through. Install circlip on the retaining pin to secure clevis.
 - 2.1. For M8 Softails and Pan Americas install the rotating spring into the hole in the clevis identical to stock pegs before sliding retaining pin through.

****Note: The DXP clevis features a set screw to help with peg angle. It is threaded flush when shipped but feel free to unscrew it to match desired up-down peg angle. This can also be done once the peg is mounted.**

3. Install the DXP billet foot peg onto the tapered end of the clevis and hand tight the main peg bolt. Apply blue threadlock to the bolt.
4. Angle the peg to the desired riding position and tight the main bolt to **25 ft-lbs**. This will force the cone into the tapered end securing peg angle.
5. If you need to adjust the billet peg angle later on refer to the clevis position install diagram lower.

Message us for any further questions.

info@ridedxp.com



INSTALLATION GUIDE

DXP FOOT PEG

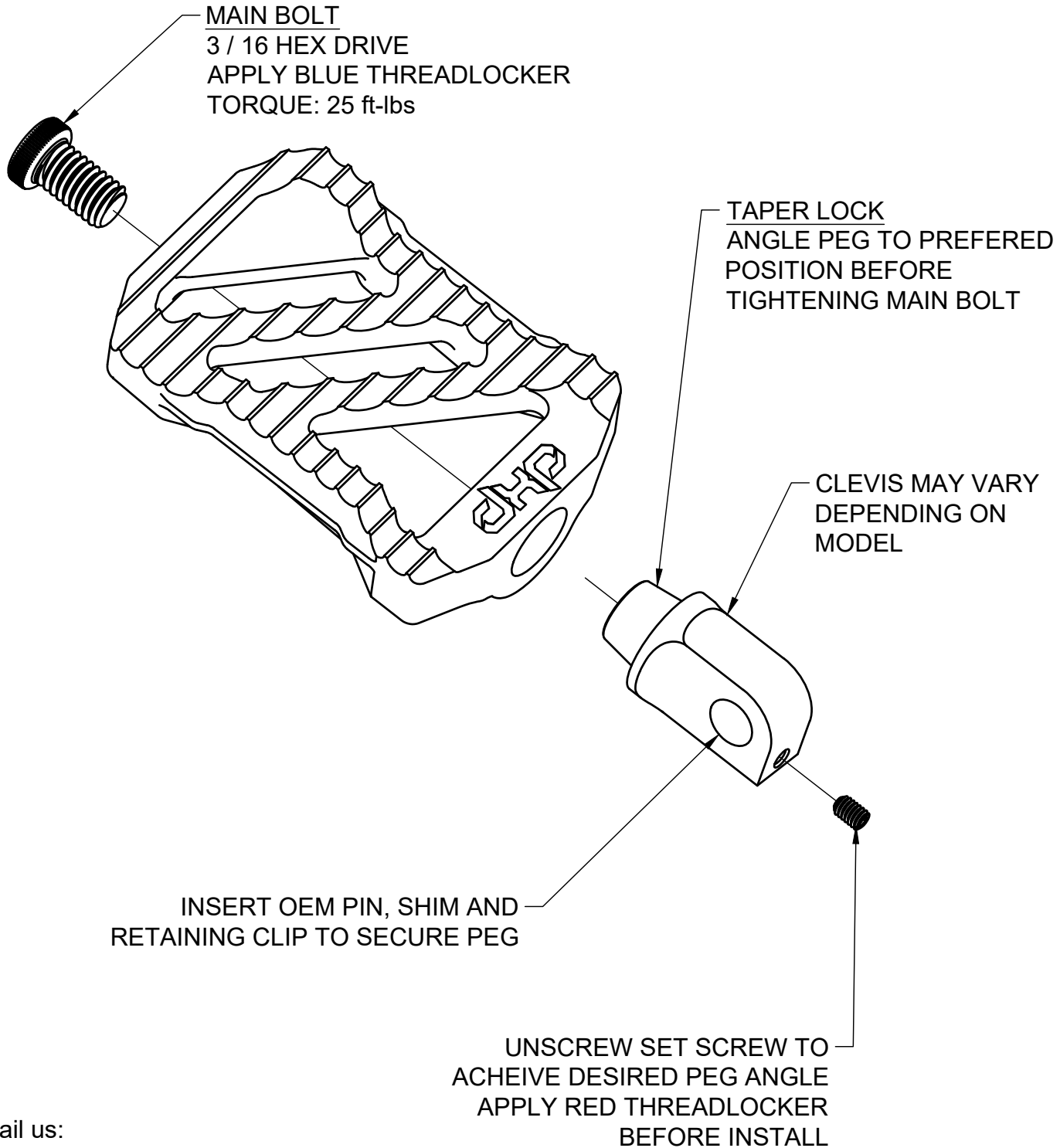

For help email us:
info@ridedxp.com



INSTALLATION GUIDE TO RE-AJUST TAPER LOCK ANGLE

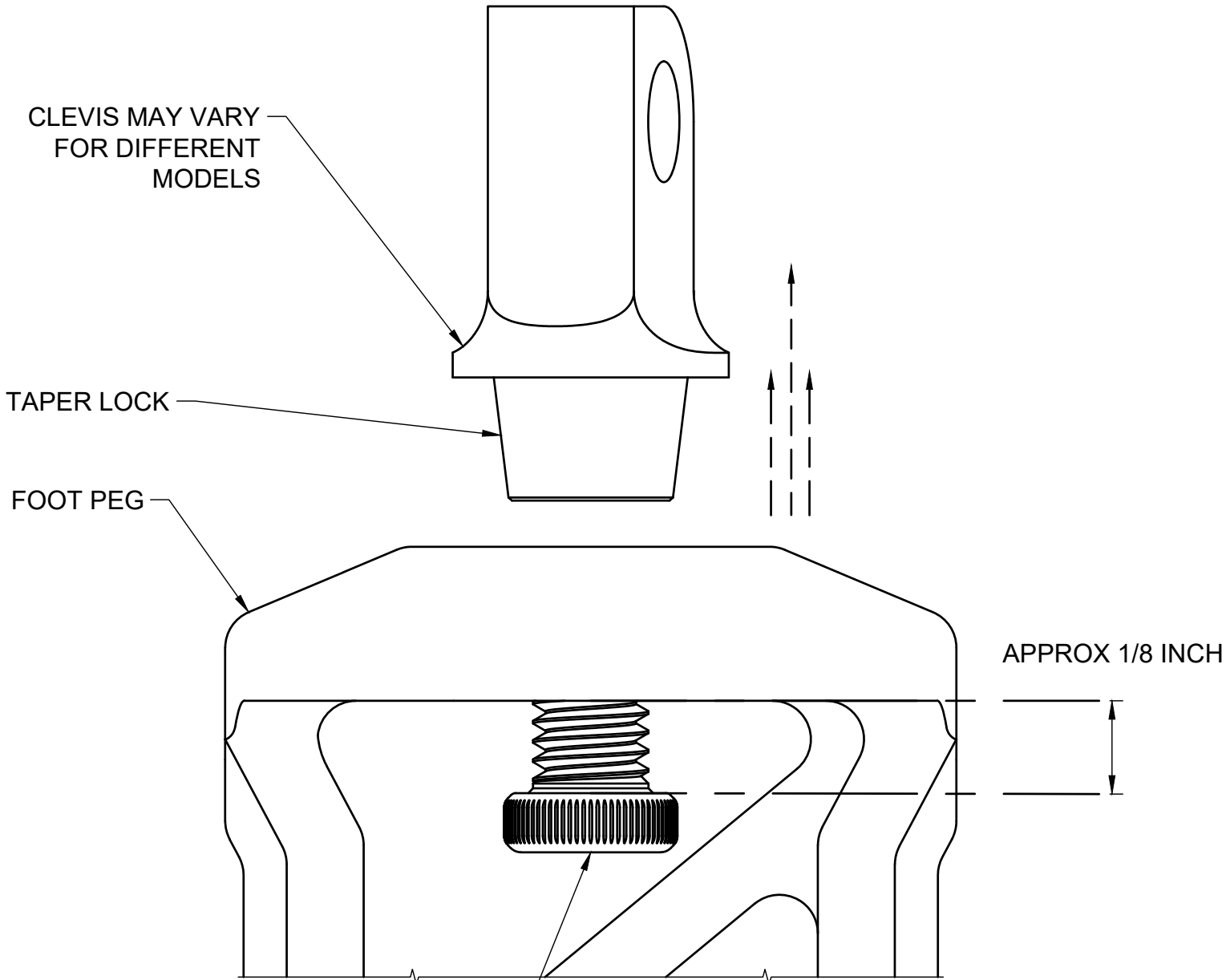

- IF THE TAPER LOCK IS STUCK
1. UNSCREW MAIN BOLT OUT 1 / 8 INCH
 2. HIT FIRMLY USING ALLEN SOCKET AND HAMMER
 3. ROTATE PEG TO DESIRED ANGLE
 4. RE-THREADLOCK AND TORQUE MAIN BOLT 25 ft-lbs

For help email us:
info@ridedxp.com